

woven carpet maintenance, cleaning & installation guide



feltex | woven



quality & design woven together

For more than 60 years, Feltex has been synonymous with some of the finest woven carpet in the world.

All Feltex Woven products are made from a rich blend of top quality wools. Using time honoured methods, Feltex combines traditional weaving skills with the latest technology to craft a range of exceptional woven carpets.

Feltex Woven offers an extensive selection of woven carpets for use in residential and commercial environments.

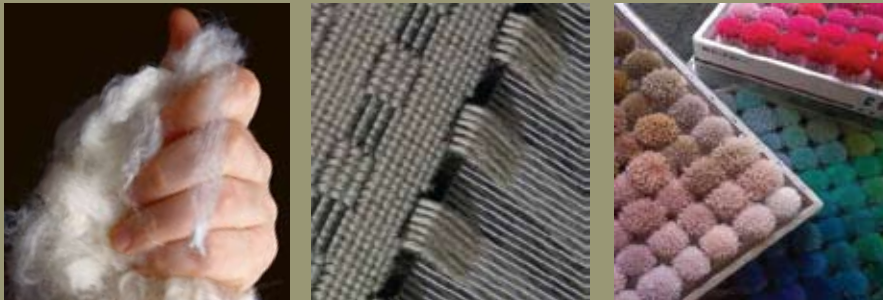

Maintaining Your Investment in a Feltex Woven Carpet

Nothing looks more stunning than quality and design woven together in the finest wools.

Feltex Woven carpets exquisite patterns and colours are designed for visual appeal.

Feltex Woven wool and wool rich carpets are designed to provide a high level of performance in both commercial and residential applications.

Proper installation and maintenance can significantly increase the life of a woven carpet. This guide outlines the key requirements for installation, cleaning and maintenance of Feltex Woven carpets.

Selecting the Right Woven Carpet

Selecting the right woven carpet for a specific commercial or residential environment is vital.

It is important to select a woven carpet that is aesthetically appealing and meets the specifications required for the installation application.

Considerations such as floor traffic volume and location, likely spillage quantity and type should be given.

Colour and pattern affect the capacity of a woven carpet to conceal soils and stains. Texture and construction are key factors in carpet performance. Soil can penetrate a carpet with loose construction and be difficult to remove. A tightly woven carpet is better able to keep tracked in soiling on the surface for easier removal.

A good quality underlay particularly on stairs, can extend the life of the carpet and also provide a more comfortable walking surface.

Why Wool

Feltex Woven carpets are made from the finest wools and wool rich blends. Wool is renowned for being warm and luxurious, whilst being naturally resilient to wearing, staining, soiling and fire.

Fire Resistance

Resistance to fire is important, particularly in a commercial facility.

All woven carpets manufactured by Feltex meet AS/NZS 1530 Class 9A and Class 9B for assembly areas in commercial buildings.

The Importance of Proper Maintenance

The life of a woven carpet can be maximised with regular maintenance.

A well planned cleaning program helps minimise soiling and maintain the condition of a woven carpet.

Every building will have cleaning requirements depending on traffic levels, building usage and external conditions.

For commercial installations, a comprehensive maintenance program should be developed in accordance with AS3733 and this guide, inclusive of budget covering staff levels, training, cleaning equipment, products and cleaning frequency.

A program should start with a floor plan showing key soiling areas of the building. This can be up to 30 percent of the entire floor area.

Four Steps to Successful Maintenance

There are four key elements in an effective maintenance program:

- **Strategic prevention**
- **Regular vacuuming**
- **Removal of spots and soils**
- **Periodic deep cleaning**

Strategic Prevention

Preventative maintenance is easier and more economical than the cleaning of soiled carpet.

Keeping Out the Outside

Soil pickup is minimised by keeping outside areas such as driveways, parking areas and paths as clean as possible.

The provision of a non asphalt entrance to buildings will reduce the amount of asphalt residue brought inside

Soil Control Matting

One of the most efficient ways to reduce carpet damage is soil control matting placed at strategic entry points such as:

- All entries
- Lift and stairwell entries
- Vending machines
- High spillage areas (e.g. dining rooms)
- Foyers and hallways

Mats at least six footsteps or approximately five metres from the entrance of a commercial installation will trap approximately 80 percent of soil before it gets transferred onto the carpet.

Maintenance of soil control matting is just as important as carpet maintenance.

Mats should be cleaned regularly as part of programmed maintenance and replaced once soiled.

Chair Pads

Do not place chairs or trolleys with rollers or castors on woven carpet without a chair pad. Continued use without a chair pad can crush the pile and cause irreversible damage to a woven carpet.

Rugs

In residential applications, scatter rugs or carpet protectors can be used in high traffic areas and in front of chairs to protect carpets from localised and uneven wearing. Rugs should be cleaned regularly, at which time the pile of carpet underneath should be cleaned and restored. Colourfastness of rugs should be checked before use, as the colour in some rugs may bleed through. After cleaning, allow carpet to dry completely before replacement of rugs.

Chemicals

Exercise extreme caution with bleaches, tile cleaners, mildew removers, oven cleaners, drain openers, plant food and the like. They are strong chemicals that can permanently discolour or dissolve carpet fibres.

Direct Sunlight

Carpet should be protected from prolonged periods of direct sunlight with curtains, blinds or awnings.

Regular Vacuuming

Soil particles, silica and sand can damage carpet fibres through abrasion, wear and discolouration.

Walking on soiled carpet enables the soil particles to work their way below the surface of the pile, making them more difficult to remove.

The most effective way to minimise soiling is by a planned program of regular vacuuming. Vacuuming prolongs the life and enhances the appearance of the carpet.

Frequency of Vacuuming

Frequency of vacuuming will depend upon the use of the carpet. In residential applications, carpet should be vacuumed at least weekly. In high traffic areas, more frequent vacuuming is required to ensure soil and grit is removed before it works its way below the surface of the pile, where it is far more difficult to remove and can abrade and dull the appearance of the carpet.

In most commercial applications, vacuuming is likely to be required more regularly (up to daily in areas of heavy or frequent traffic flow).

Several passes should be made over each area to ensure effective removal of soiling material. Three vacuum passes for light soiled areas will usually be sufficient and five to seven passes for heavily soiled areas. Vacuuming first against the natural pile will help lift the pile, unsettle and remove dirt and grit and reduce matting. When finishing, vacuum in the direction of the pile to achieve a uniform finish.

Equipment Selection

Vacuum cleaner performance will directly affect the longevity and presentation of the carpet. Vacuuming should be undertaken using a quality upright vacuum cleaner with a pile beater, preferably with dual motors (one motor powering the brush to agitate pile and the second motor providing strong suction) for commercial applications.

The pile beater may consist of revolving bristle strips or a beater bar/bristle strip combination. Revolving bristle strips are more suitable for direct stick carpets. A beater bar/bristle strip combination is more suited to carpets installed by the stretch-in system over underlay. It is recommended that both types of vacuum cleaners have an adjustable height beater. The height should be checked and adjusted

each time the cleaner is used, to ensure that the carpet pile is not damaged by beating that is more vigorous than necessary. Carpet sweepers and suction cleaners without beater attachments may be used at any time for surface touch-up. Their use is to be in addition to, not in lieu of, regular scheduled vacuum cleaning with an upright beater cleaner.

Breathe Easier

Effectiveness of vacuuming is limited if minute particles from the carpet become airborne. If the vacuum cleaner is fitted with a HEPA (High Efficiency Particulate Air) filter, it is rated to retain 99.97 percent of all particles as small as 0.3um in size and will ensure that fine particles (such as dustmite allergens) are removed and stay in the collection bag (particularly important for dust sensitivities).

Removal of Spots and Spills

Take Immediate Action with Spills

Immediate attention to spills is the key to successful spot removal. If spills are left unattended they may become extremely difficult, if not impossible to remove and result in permanent damage and discolouration.

In commercial applications, spot cleaning should be carried out on a daily basis in all areas, as described in Appendix B1 of AS/NZS 3733. If a cleaning contractor is employed, it may be necessary for maintenance staff to attend to spot and stain removal to avoid the setting of stains, rather than waiting for attendance of the contractor. Spotting kits as described in section 3.4 of AS/NZS 3733 should be made available for maintenance staff for immediate use when necessary.

Action for Spills

1. Immediately remove as much of the spill as possible. Use a spatula to scoop up as much substance as possible. Blot with an absorbent white cloth working from the outer edge towards the centre to avoid the spill spreading. Never rub or scrub abrasively as a fuzzy area may result.

2. Determine the appropriate method of stain removal. In residential applications, most common household stains may be treated with warm (not hot) water applied to the stained area. Then using a white cloth or sponge, apply a mixture of one teaspoon of approved wool laundry detergent and one teaspoon of white vinegar in 1 litre of warm water. Rinse with warm water, repeating treatment until no stain is evident. For other stains, refer to the table in this guide and/or Appendix B1 of AS/NZS 3733. Supermarket cleaning products are not recommended. Always pre-test your cleaning agent on an inconspicuous area of carpet or a spare piece to ensure it won't mark. Do not scrub.

3. Press dry the carpet with a clean white cloth or white paper towel between each step in the treatment process to remove excess moisture. Do not rub as rubbing can alter the texture of the carpet.

4. After the stain has been treated, place several layers of white paper towels over the area and place a flat weight on them until dry. Do not walk on the carpet until dry.

5. If stain fails to respond adequately to treatment call a professional carpet cleaner immediately.

Removal of stains cannot be guaranteed and no responsibility is accepted by Feltex Carpets for claims arising from any proposed treatments.

Periodic Deep Cleaning

All woven carpet should be periodically cleaned using the hot water injection and extraction method ('steam cleaning') with a smooth wand attachment, where a fine spray of water and detergent solution is applied to the carpet and extracted by a vacuum in one pass.

Feltex Carpets does not recommend shampooing, dry cleaning or do-it-yourself steam cleaning of woven carpet.

Hire a Professional

The skill of the operator in applying and extracting the cleaning solution is critical in ensuring the woven carpet is not over wetted which can cause shrinkage, rapid resoiling and odor. Steam cleaning should always be performed by a reputable professional cleaner (who is a member of a professional association) in accordance with the Australian/New Zealand carpet cleaning and maintenance standard (AS/NZS 3733-1995) and the following additional guidelines:

- Detergents and other chemicals used in hot water injection solution should be of pH8 or lower in their concentrate form. The solution sprayed from the head or wand shall have a pH in the range of 5.0 to 7.0, as measured with a pH test paper capable of indicating in increments of 0.5 pH units.
- High alkaline pre-treatment should be avoided, or if used, must be sufficiently neutralised, diluted and extracted by the hot water injection and extraction, so that a moistened pH test paper applied to the carpet surface gives a reading of 5.0 to 7.0. The carpet pile must not remain in an alkaline condition.

- If alkaline pre-treatment is used, it will assist in the neutralisation process if the hot water injection solution is at the lower end of the pH range of 5.0 - 7.0. The pH can be adjusted using dilute acid - for example, dilute acetic acid (white vinegar) or acidic brownout solution.
- Hot water injection solution shall be maximum of 50°C in the solution tank.
- Efficiency of the vacuum system of the hot water injection and extraction unit must be equivalent to that of a good truck mounted unit. Some portable 'steam cleaning' systems have insufficient extraction power to adequately remove moisture from the carpet.
- An adequate flow of drying air must be provided to allow the carpet to dry out in a reasonable time. Because each floor of a modern building is effectively sealed, the air conditioning system should be run at a temperature of 20°C to 25°C while the carpet is being cleaned and then for a further 24 hours after completion of cleaning. Relative humidity should not exceed 55 to 60% during this time.

How Often?

Frequency of professional steam cleaning is dependant on the level of traffic, amount and type of soiling and regularity of vacuuming.

Generally, for residential applications, carpet should be professionally steam cleaned every 12 to 18 months. In commercial applications, key soiling areas should be cleaned every six months and given an overall clean at least once every year, although a very harsh environment may necessitate monthly cleaning.

See recommended commercial sample cleaning schedule. Table 1

Restoration of Badly Soiled Woven Carpet

Woven carpet that has not been subject to a regular vacuuming and general maintenance program may become matted and extremely soiled.

In some instances it may be unsalvageable, but in many cases woven carpet can be made serviceable with an intense restoration program.

Restoration should be carried out by a carpet cleaning professional and may include:

- Erecting pile with a pile lifter
- Rotary brush shampoo
- High temperature hot water extraction with acid rinse only, no detergent
- High temperature hot water extraction with detergent

Please note, procedures like this are a last resort as they are expensive. Preventative maintenance is recommended.

Table 1

Commercial cleaning guide given specific traffic levels

| Traffic Level & Cleaning Method | Cleaning Frequency | Cleaning Frequency | Cleaning Frequency | Cleaning Frequency | Cleaning Frequency |
|---------------------------------|--------------------|--------------------|--------------------|--------------------|--------------------|
| | Hospitality | Education | Food Service | Corporate | Retail Office |
| MODERATE | | | | | |
| Vacuum | Daily | Daily | Daily | Daily | Daily |
| Spot removal | Daily | Immediately | Daily | Daily | Daily |
| Interim cleaning | 60 Days | 60 Days | 21 Days | 60 Days | 21 Days |
| Deep cleaning | 180 Days | 180 Days | 120 Days | 180 Days | 120 Days |
| HEAVY | | | | | |
| Vacuum | Daily | Daily | Daily | Daily | Daily |
| Spot removal | Daily | Immediately | Daily | Daily | Daily |
| Interim cleaning | 30 Days | 30 Days | 14 Days | 30 Days | 15 Days |
| Deep cleaning | 120 Days | 120 Days | 90 Days | 120 Days | 90 Days |
| EXTRA HEAVY | | | | | |
| Vacuum | Daily | Daily | Daily | Daily | Daily |
| Spot removal | Daily | Immediately | Immediately | Daily | Daily |
| Interim cleaning | 15 Days | 15 Days | 7 Days | 15 Days | 7 Days |
| Deep cleaning | 90 Days | 90 Days | 30 Days | 90 Days | 15 Days |
| WALK OFF AREAS (MATS) | | | | | |
| Vacuum | Daily | Daily | Daily | Daily | Daily |
| Spot removal | Daily | Immediately | Daily | Daily | Daily |
| Launder | 7 Days | 7 Days | 7 Days | 7 Days | 7 Days |

General cleaning guide by stain type and treatment

| Stain Type | Order of Treatment | | | Cleansing Agent/Treatment: |
|---------------|--------------------|--------|--------|---|
| | Step 1 | Step 2 | Step 3 | |
| Blood | 1 | 2 | 8 | <ol style="list-style-type: none"> 1 Cold water 2 1 teaspoon mild laundry detergent approved for wool and one teaspoon of white vinegar in 1 litre of warm water 3 Chill with aerosol freezing agent or ice cubes in a plastic bag. Pick or scrape off gum 4 Clear nail polish remover without lanolin 5 Rust remover (to be applied by a professional carpet cleaner) 6 Clear household disinfectant 7 Vacuum immediately. If any residue call professional carpet cleaner 8 Rinse with warm water |
| Chewing gum | 3 | 2 | 8 | |
| Coffee | 2 | 8 | | |
| Faeces | 2 | 6 | 8 | |
| Nail polish | 4 | | | |
| Paint (latex) | 1 | 2 | | |
| Rust | 5 | | | |
| Soot | 7 | | | |
| Urine (fresh) | 1 | 2 | 8 | |
| Urine (old) | 2 | 8 | | |
| Vomit | 2 | 6 | 8 | |
| Wine (white) | 2 | 8 | | |



Recommended Installation for Feltex Woven Carpet

All Feltex Woven carpets are to be installed in accordance with AS/NZS 2455.1 or as recommended by Feltex Carpets.

Storage

Feltex Woven carpets are to be stored in a well ventilated, clean and dry environment, on a flat, clean, dry surface preferably suspended from the subfloor.

Conditioning

Carpet should be cut to the required length and laid into position for a period of approximately 24 hours to allow it to acclimatize. The preferred ambient temperature is between 10° to 30° C.

Under Floor Heating

Where floor heating is operable, heating equipment should be turned on prior to carpet installation to ensure that the relative humidity does not exceed 70 percent.

Heating equipment is then to be turned off to allow the floor to cool and to remain turned off until 48 hours after the installation is completed.

Underlay

All carpet should be installed on new underlay compatible with the quality and proposed use of the carpet (which should comply with the appropriate classification for the intended use/application as per AS4288-2003 i.e. light residential, general, luxury, commercial or heavy commercial), the underlay and carpet being designed to work together as a complete flooring system. Generally quality underlay will extend the life of your carpet, while giving better resilience and comfort.

Installation of underlay is to be as per underlay manufacturers' instructions.

Subflooring Condition and Preparation

The subfloor is to be dry, smooth, plane, sound and clean. For double bond/direct stick, porous subfloors shall be primed.

Clean

All deleterious matter and oil or paint substance is to be removed from the subfloor prior to installation.

Smooth

A smooth condition requires that when a 150mm long straightedge is placed on the surface, at any point no part is more than 1mm below the straightedge.

Plane

A plane or level condition requires that when a 3000mm (3m) long straightedge is placed on the surface in any position, no part is more than 3mm below the straightedge.

Dry

The subfloor is considered dry when its relative humidity does not exceed 70 percent, the moisture content of concrete does not exceed 5.5 percent, or a timber subfloor does not exceed 15 percent.

All measurements are taken by using the methods specified in Appendix B of the AS/NZS 2455.1.

Subfloor repair and preparation is to be in accordance with AS/NZS 2455.1.

Carpet Installation

Feltex Woven carpet may be installed by traditional stretch over soft underlay, double bond over soft underlay or by direct stick to a suitable subfloor utilising a number of seam

joining techniques. Careful consideration should be given to the appropriate method suited to the installation, taking into account all criteria including pattern matching, roll lengths and end use.

Planning - General Layout

Where practical, a woven carpet should run the length of the area installed, to enable traffic flow along rather than across the woven carpet widths. The pile direction should face toward the main entry to the installed area.

Woven carpet on stairs must be installed with the pile lay running down the stairs. *A little hidden extra carpet should be folded back at the top and bottom of the stairs so, as the edges of the tread are worn down, the carpet can be moved to hide the wear point.* It is recommended to purchase extra carpet to redo stairs at a later stage if they are likely to receive a lot of wear.

The full width of a woven carpet is to start on the entrance side with part width fill outs on the opposite side. Part widths are not to be placed between full widths of woven carpet and part widths are not to abut each other. Selvage seam joins are to be accurately aligned with each other.

Seam Joining

Feltex Woven carpets are manufactured in a manner that allows the woven carpet to be joined selvage to selvage utilising hot melt tape. However, narrow loom woven carpet can be made to order with either sewn or hot melt seams.

Hot Melt Seams

Hot melt tape must be compatible with the woven carpet. The hot melt tape must maintain a bond under pressure, for the life of the woven carpet.

Sewn Seams

Seams are to be sewn at an even tension with a stitch rate of 35-40 stitches per 5cm. All cut edges of the woven carpet are to be sealed with an appropriate adhesive. The stitch rate of hand sewn cross joins should be maximum 10mm spacing and reinforced with joining tape.

Cross Joins

An appropriate seam adhesive should be applied to the cut backing yarns and when dry, the prepared cross joins should be hot melt taped.

Hand sewn cross joins (if preferred) should be re-enforced with hot melt tape applied with the woven carpet face down. All cross joins should be cut and prepared in a manner that assures accurate pattern alignment is achieved.

Some loop pile woven carpet by their inherent construction, are difficult to cross seam to a satisfactory standard. All care in the planning should be undertaken to alleviate cross joins wherever possible.

Pattern Sequence & Alignment

When making a seam on patterned woven carpet using hot melt tape, accurate pattern matching is best achieved with the woven carpet laid flat and even, but not under tension. Any variation in the pattern match of adjoining widths can be eliminated by compressing the variation rather than stretching, to bring the pattern into sequence. The woven carpet may then be stretched. Hot melt tape is manufactured in a manner that allows it to be stretched in the length, equal to the woven carpet to which it is bonded.

Years of research and inquiry have failed to find a reason to explain the underlying cause, such that it is considered a phenomenon related to the location of the carpet which can not be predicted or prevented. It is not a manufacturing defect and apart from affecting appearance, has no detrimental effect on the performance of the carpet.

However, as this characteristic can affect the appearance of a carpet, you are advised to discuss this with your retailer when considering your purchase. Further information on permanent pile reversal is also available from the Carpet Institute of Australia.

Shift Lines

Shift lines are parallel lines appearing on the surface of patterned loop pile carpets at regular intervals, due to the nature of construction of the carpet. Lines may be more apparent with "large" designs or patterns. Colour, directional pile lay and light sources are also contributing factors, as certain light sources shining across the carpet may accentuate these lines in the form of shadowing. This is not a manufacturing defect and will not affect the wear or durability of the carpet.

Shedding

Shedding is a normal characteristic of cut pile carpets, particularly staple or spun yarn products, caused by some of the outside fibres of yarn bundles becoming detached during early carpet wear stages. Regular vacuuming with a vacuum cleaner with a beater bar will remove most of the loose fibres during the first year.

Design Characteristics

Where carpet design includes the random use of contrasting colours, at times these colours can coincide in production, causing an effect known as phasing. Similarly in loop pile carpets, shading effects of colour patterning can appear as paneling down the length of the carpet. Both phasing and paneling are an accepted part of the design and in no way affect the performance of the carpet.

Appearance Retention

All carpets will change in appearance over time, primarily due to foot traffic.

Matting is the merging together of carpet tufts to where they may become less defined, and in a patterned carpet, can result in a loss of sharpness of pattern. Matting occurs in all tufted carpets to some degree, but is more likely to occur in high traffic areas (eg. in front of seating areas, doorways etc).

Though induced by wear, it is often caused by failure of underlay, or improper maintenance, including inadequate vacuuming and/or inappropriate or ineffective treatment of spots and spills. Matting is not considered a manufacturing fault unless it happens rapidly or to an unacceptable degree.

Fuzzing or blooming is caused as the tips of the tufts in a cut pile carpet, over time and use, lose a degree of yarn twist. Most apparent in traffic areas or in front of chairs, this is normal and should be expected. Generally fuzzing can be corrected by shearing away the cobweb of fibres on the installed carpet, with use of a special machine.

Pattern Matching/Bowing & Skewing

Feltex Carpets use the best available techniques to minimise pattern distortion during manufacture. However, the extensible nature of textile products means that some distortion due to shrinkage or stretch during and after manufacture is unavoidable, so repeating patterns may not precisely match along the length or width of carpet or from one production run to another. Installation methods and site and storage conditions can also contribute to instability in the pattern, such that perfect pattern match cannot be guaranteed.

Installation of patterned carpet will require more time, effort and skill which should be considered in the original labour quotation. A competent carpet layer should be able to obtain

a close pattern match in most circumstances, though some irregularities may still be visible in the horizontal, vertical and diagonal pattern or texture, especially when viewing across multiple width installations. If concerned, please discuss further with your carpet retailer and/or carpet layer.

Further, all carpets are subject to some degree of bowing and/or skewing. Bowing of up to 40mm over any single width of carpet is generally acceptable. Full details of the tolerances of Feltex carpets are set out in the Feltex Carpet Installation Recommendations (available Freecall 1300 130 239 or visiting www.feltex.com).

Wrinkling (or Rucking)

Wrinkling may occur after installation. It can be caused by excessive humidity, inadequate underlay, or not using the recommended installation procedures, especially relative to power stretching. A competent installer can usually correct this problem.

Fading

All Feltex carpets meet ACCS standards for lightfastness. However, carpets like all other dyed textiles, will slowly lose colour over time when exposed to direct sunlight. Carpet should be protected from prolonged periods of direct sunlight with curtains, blinds, shades, or awnings and furniture moved periodically to expose all areas evenly.

Dramatic colour change can also occur as a result of ozone, emissions from heating fuels and air-conditioners, pesticides, cleaning agents, benzol peroxide, and other household items. Care should be taken when using these items. The occurrence, known as ozone damage, is largely unexplained, but appears to be more prevalent in coastal areas with a high ultra-violet content. Some colours are more susceptible than others. If you believe there may be risk of ozone damage, please discuss your choice with the retailer.

As ozone damage is largely random and unexplained, it is not considered a manufacturing defect and does not effect the performance of the carpet.

Missing or Damaged Tufts

Sometimes upon stretching of carpet during installation, or following damage caused by pets scratching or moving of furniture, tufts are damaged or identified as missing. In the case of loop pile carpets, tufts can be pulled from the backing resulting in long, lengthwise pulls of the carpet.

Sprouts, or snagged tufts, can be easily trimmed without damaging the carpet and missing or damaged tufts can be easily replaced by hand or by re-tufting, and can be readily fixed on site by a skilled installer or carpet professional. It is recommended a small piece of spare carpet be retained to provide a source of additional tufting yarn.

Moths and Carpet Beetles

All Feltex woolen carpets have insect resist treatments applied during manufacture. However, moths/beetles in some areas have developed a tolerance to treatments.

Good housekeeping is essential to control textile pests. Regular vacuuming along skirting, under furniture and in corners will discourage insects and reveal any infestations at an early stage.

If you believe there maybe a minor infestation, you should thoroughly vacuum the area (spraying the contents of the vacuum cleaner with insecticide prior to disposal) and treat the infested area, extending 15cm beyond the boundaries of the activity, with an insecticidal aerosol spray or dust, following the manufacturers' directions and precautions. In the case of serious infestations, or if the initial treatment is not successful, it is recommended that you contract a professional pest control operator.

Installation Methods

Stretching Over Soft Underlay (carpet gripper method)

Carpet gripper and soft underlay is to be installed in accordance with AS/NZS 2455.1.

A tubed power sticher, aided by a knee kicker should be used for woven carpet installation.

The woven carpet is to be installed flat, taut and evenly tensioned in both its width and length. Refer to Power Stretching Sequence.

It is a characteristic of Axminster woven carpet, that there will be more stretch in its length than its width.

Double Bond or Direct Stick Method

When the double bond method is utilised, the underlay is to be installed in accordance with the manufacturers' recommendations.

When installed using the double bond or direct stick method of installation, woven carpet should be installed to a minimum tension.

Tension is only to be applied to the carpet to remove all slackness from the carpet whilst maintaining correct pattern alignment. Feltex Carpets recommends double bond and direct stick seams be made utilising appropriate low profile heat bond tape.

All cut edges must be seam sealed using appropriate sealing adhesives (for further information with regard to adhesives and carpet seaming tape application, refer to the Product Data and Material Safety Data Sheets available upon request from adhesive manufacturers).

Power Stretching Sequence

Axminster Carpet

AS/NZS 2455.1.2007, Appendix C, C4

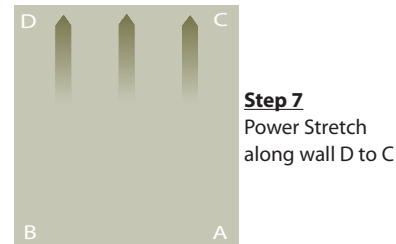
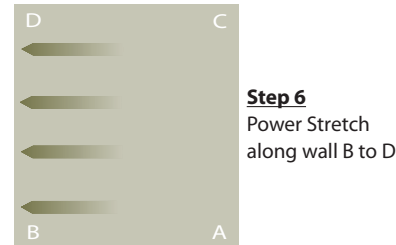
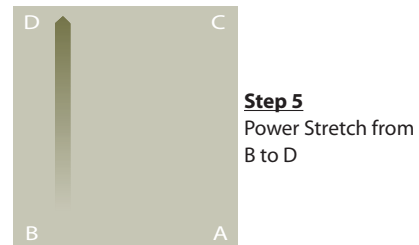
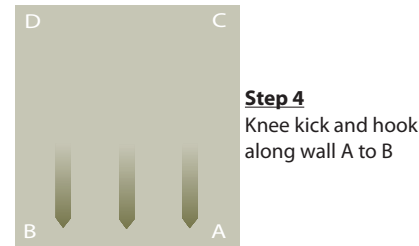
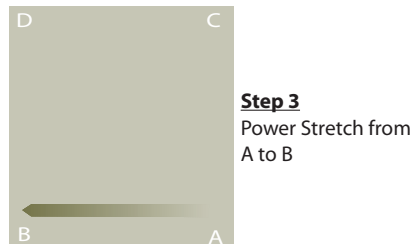
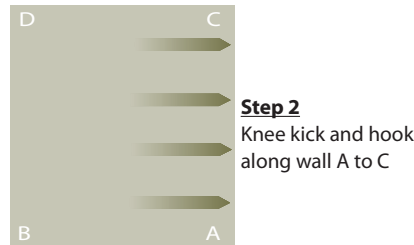
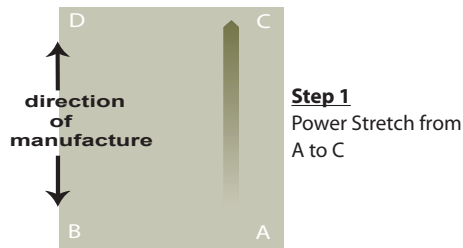

Feltex Woven Performance Characteristics

Colour Variation

It is normal for installed woven carpet to show minor colour variation from selling samples or minor variations between production runs and dyelots. Feltex Carpet's quality assurance program (which is ISO9000 accredited) seeks to minimise potential for variability and ensure any variation is within recognised textile industry standards.

It is also noted colour appearance can vary depending upon type of light under which a sample is viewed and the light sources where the carpet is installed. You should seek to view the sample at your residence and under as many different light conditions as possible prior to making your final decision.

Pile Reversal Shading & Disturbance

Light can play strange tricks with carpet, making it appear from certain angles, that particular areas are lighter or darker than others. This is caused by disturbed pile reflecting the light differently to the surrounding body of carpet. This is a feature characteristic of cut pile carpets (particularly solid colour).

Sometimes the changes may be temporary, and able to be removed or lessened by vacuuming or brushing of the pile.

However, in fine cut carpets, **permanent pile reversal shading** (or watermarking or puddling) can also occur, and at times may become quite severe.



Further Information

Contact your Feltex Woven Account Manager for technical information, data sheets and product samples.

Contacts

Australia

T 1300 130 239
F 1800 654 595

New Zealand

T 0800 100 008
F 0800 488 088

USA

T 678 461 7545
F 678 461 7548

Canada

T 1 416 964 7083
F 1 416 964 7170

Great Britain

T 01562 755 112
F 01562 755 113

Singapore

T 656 841 5529
F 656 841 5250

Far East

T 852 2522 5188
F 852 2522 5187

www.feltex.com

feltex | woven

